



Art. 440900130

AHB[®]
SOLUTIONS

DIGI-SAFE BY AHB FÜR SCHLÜSSEL- UND CHIPKARTENAUSGABE

DIGI-SAFE BY AHB

FOR KEY AND CHIP CARD DISTRIBUTION



WWW.AHB-SHOP.COM 



- 1 TASTENFELD
- 2 USB-C-STROMANSCHLUSS
- 3 SCHLÜSSELHAKEN
- 4 SCHLÜSSEL-SCHUTZPLATTE
- 5 SCHLÜSSEL-AUSGABEFACH
- 6 HAUPTSCHLÜSSELLOCH
- 7 FRONTTÜR

TECHNISCHE DATEN	SPEZIFIKATIONEN
Modell	EKB2007
Stromversorgung	DC 5V, 1A (über USB-C)
Schlüsselhaken	7 Haken
Schlüsselentnahme	Automatische Freigabe per statischem Passwort, OTP oder Bluetooth
Maße	500 × 125 × 400 mm
Gewicht	6 kg
Material	Metall



SCHLÜSSEL EINLEGEN

- ❶ Mit dem Hauptschlüssel die Fronttür öffnen.
- ❷ Die Schutzplatte anheben.
- ❸ Schlüssel am gewünschten Haken einhängen.
- ❹ Schutzplatte wieder absenken.
- ❺ Tür schließen und mit dem Hauptschlüssel abschließen.
- ❻ (Empfohlen) Testen, ob Schlüssel korrekt freigegeben wird – per Passwort oder Bluetooth.





APP DOWNLOAD & REGISTRIERUNG

- QR-Code im Handbuch scannen
- oder Website: [cloudsmartlock.com/m/app.html](https://www.cloudsmartlock.com/m/app.html)
- alternativ in Google Play / App Store nach „cloud smart lock“ suchen



<https://www.cloudsmartlock.com/m/app.html>

ROLLEN IN DER APP:

Besitzer (Owner):

Wird automatisch der erste Nutzer, der die Box scannt. Hat alle Rechte.

Mitglied (Member):

Kann – je nach Berechtigung – Schlüssel freigeben, Passwörter verwalten, OTP teilen usw.



REGISTRIERUNGSMÖGLICHKEITEN:

- ❶ Telefonnummer – Code per SMS
- ❷ E-Mail – Code per Mail
- ❸ Benutzername/Passwort – frei wählbarer Account

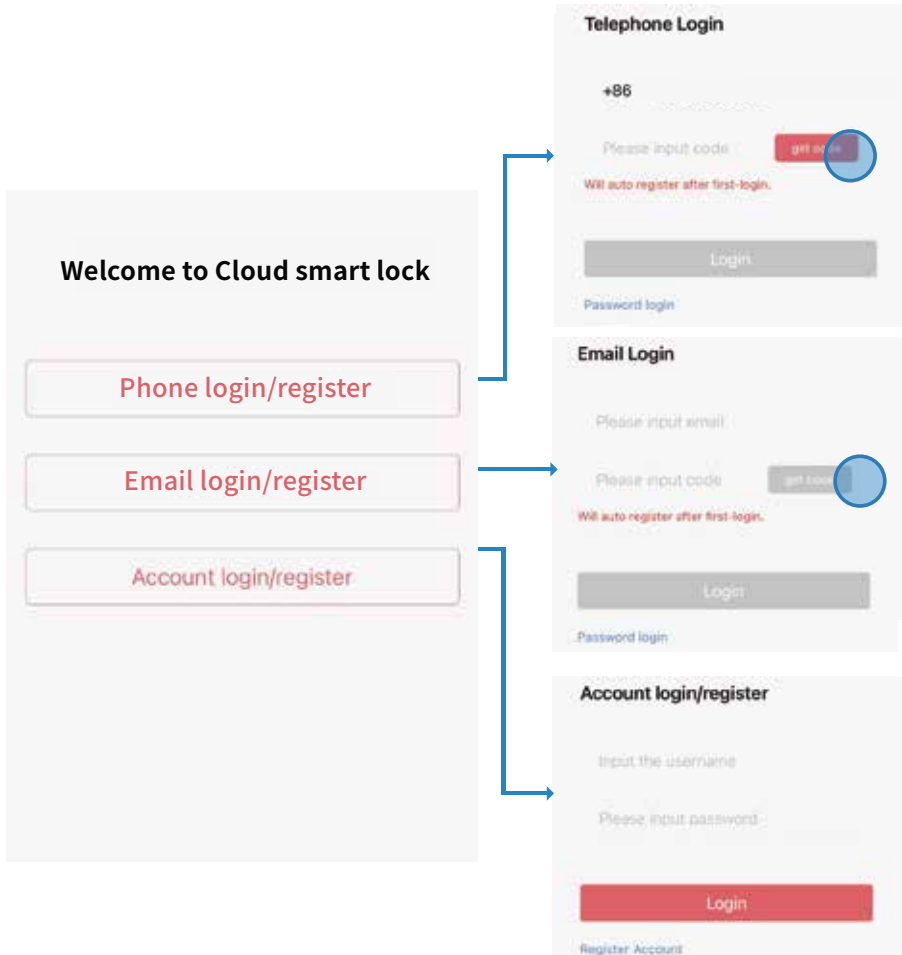



KEY BOX ZUR APP HINZUFÜGEN

- 1 App öffnen → „+“ wählen.
- 2 QR-Code auf der Front der Box scannen.
- 3 Der erste Nutzer wird automatisch der Besitzer.

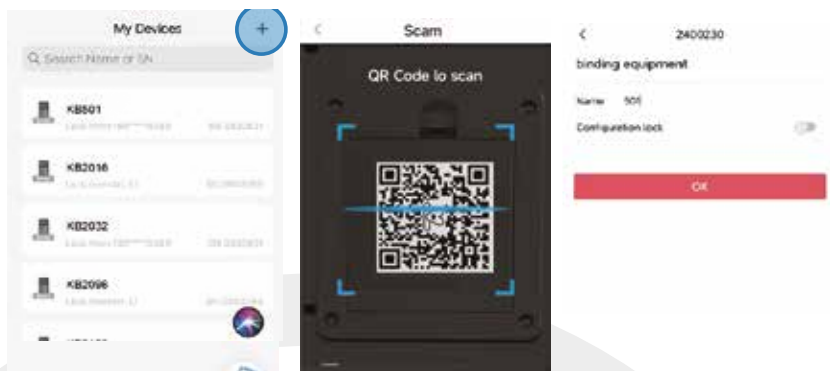

SCHLÜSSEL PER BLUETOOTH FREIGEBEN

Voraussetzung: Bluetooth am Smartphone aktiv und in Reichweite.

- 1 In der App die gewünschte Key Box öffnen.
- 2 Den benötigten Schlüssel (z. B. „1#“) auswählen und Schloss-Icon antippen.
- 3 Der Schlüssel fällt automatisch in das Ausgabefach.

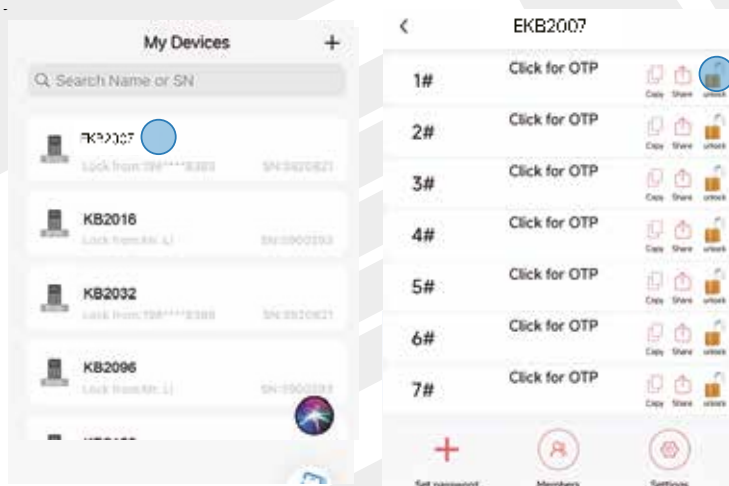



SCHLÜSSEL PER PASSWORT FREIGEBEN

Jeder Schlüssel unterstützt zwei Passwortarten:

Dynamisches Passwort (OTP)

- ❶ Wird in der App generiert
- ❷ Gültigkeit: jeweils 60 Sekunden
- ❸ Einmal verwendbar

Ablauf:

- ❶ Schlüssel auswählen
- ❷ „OTP abrufen“ tippen
- ❸ Code am Tastenfeld eingeben → Schlüssel wird freigegeben

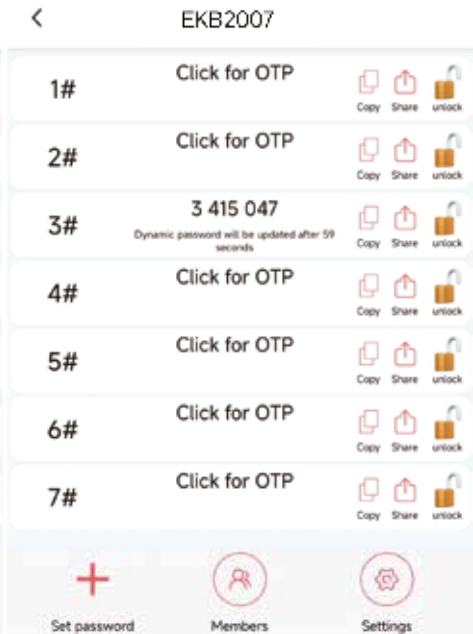
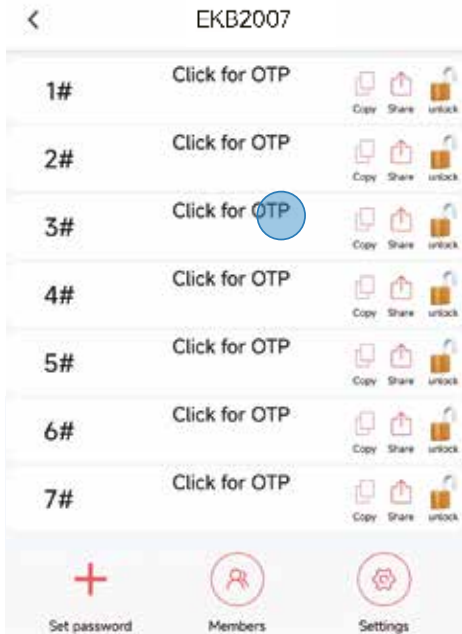



BEDIENUNGSANLEITUNG

Statisches Passwort

6-stelliger Code

- Bleibt gültig, bis er geändert oder gelöscht wird

Setzen eines statischen Passworts:

- 1 „Passwort festlegen“ wählen
- 2 Schlüsselhaken wählen
- 3 Passwort erstellen
- 4 Per Bluetooth speichern

Hinweis:

OTP und statisches Passwort können parallel existieren.

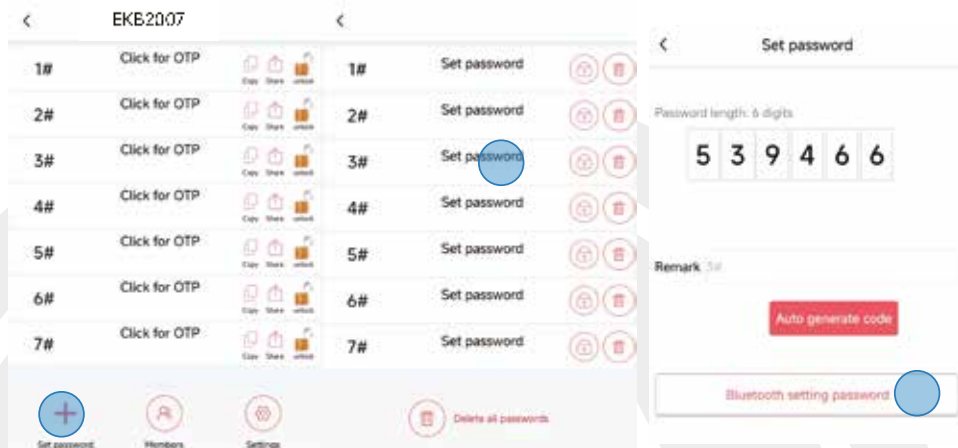



MITGLIEDER HINZUFÜGEN

Nur Besitzer oder berechtigte Mitglieder dürfen weitere Nutzer anlegen.

- 1 Menü „Mitglieder“ öffnen.
- 2 „+“ wählen.
- 3 Telefon oder E-Mail des neuen Nutzers eingeben (muss in der App registriert sein).
- 4 Berechtigungen festlegen.

Hinweis: Falls die Box beim neuen Mitglied nicht erscheint: Seite aktualisieren (herunterziehen).

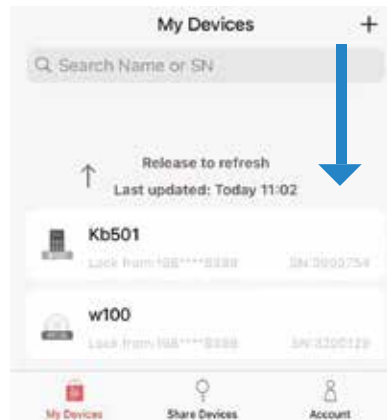
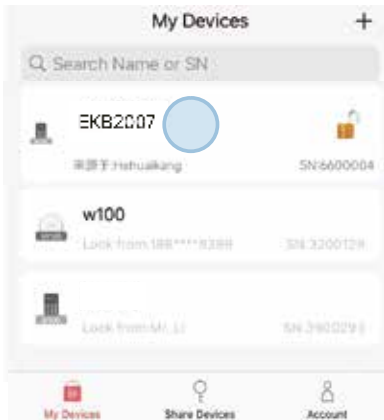
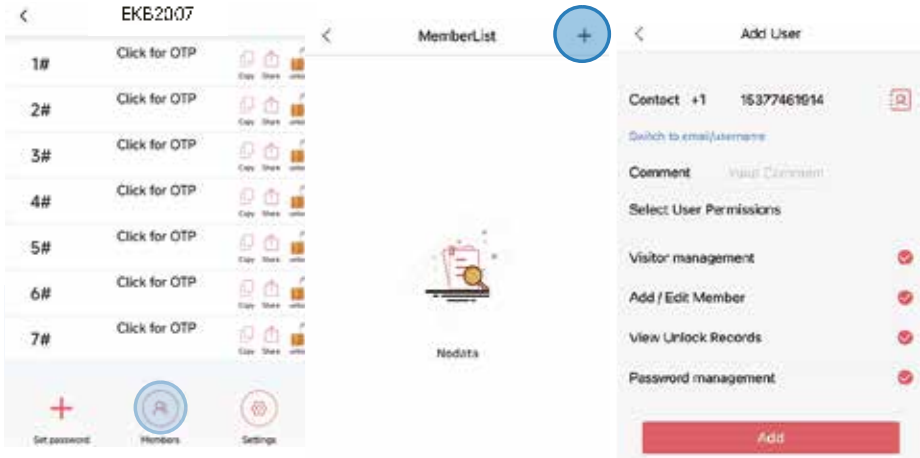



DYNAMISCHES PASSWORT PER LINK TEILEN (OTP-URL)

URL erstellen:

- 1 Key Box → Verwaltung öffnen
- 2 Schlüssel wählen
- 3 „Teilen“ → „OTP-URL hinzufügen“
- 4 Gültigkeitszeitraum einstellen
- 5 Speichern

Option: Einmalverwendung aktivieren.

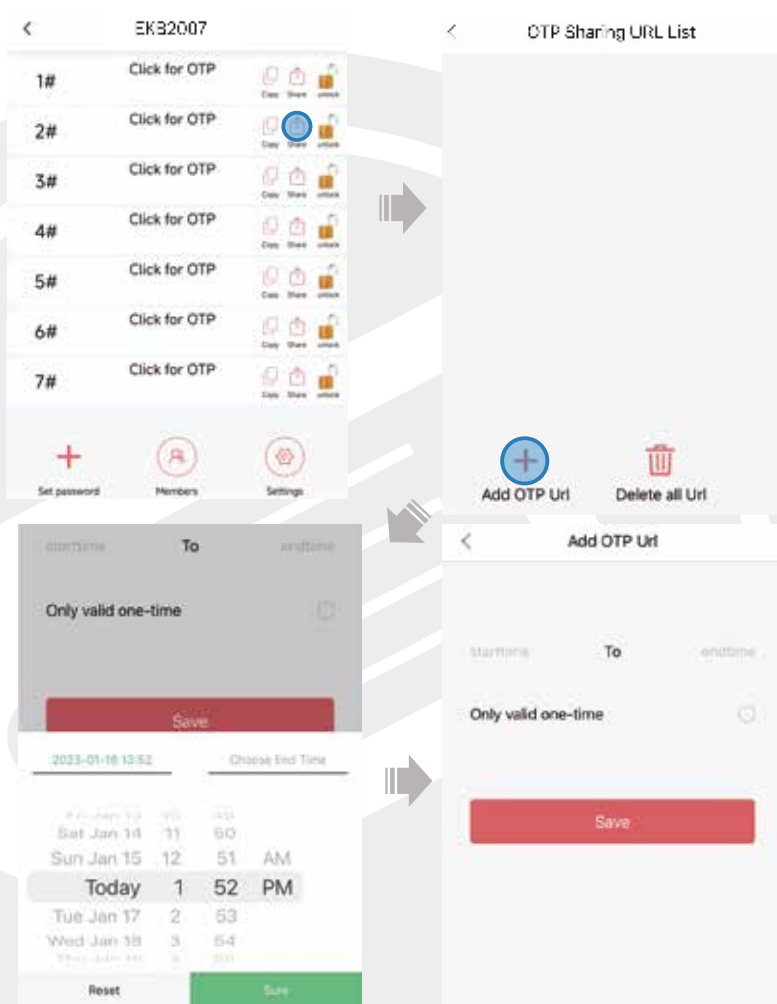



URL TEILEN:

- 1 Link kopieren
- 2 Per E-Mail, SMS usw. senden
- 3 Gast ruft Link auf → erhält OTP, das sich alle 60 Sek. aktualisiert

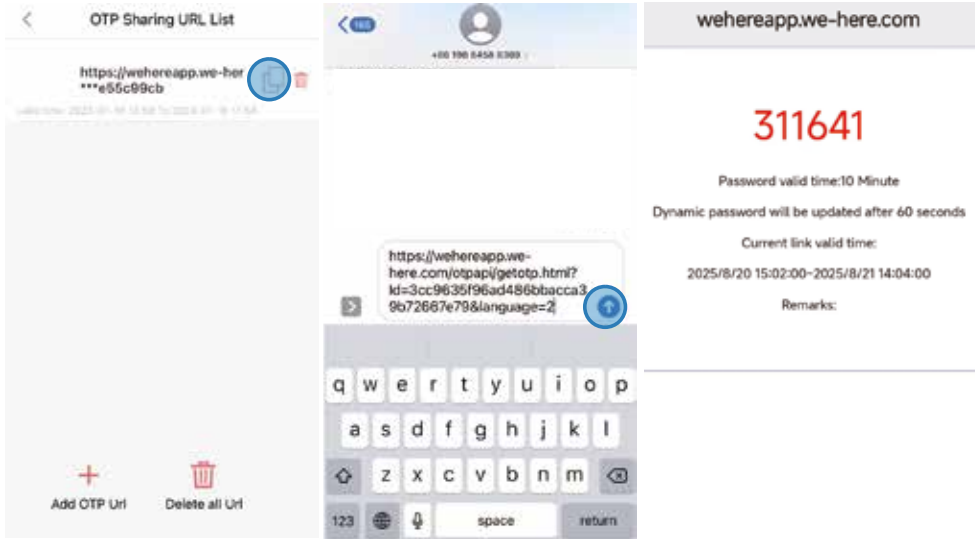

URL LÖSCHEN:

- 1 Einzelnen Link löschen oder
- 2 „Alle löschen“ wählen → danach sind die Links ungültig

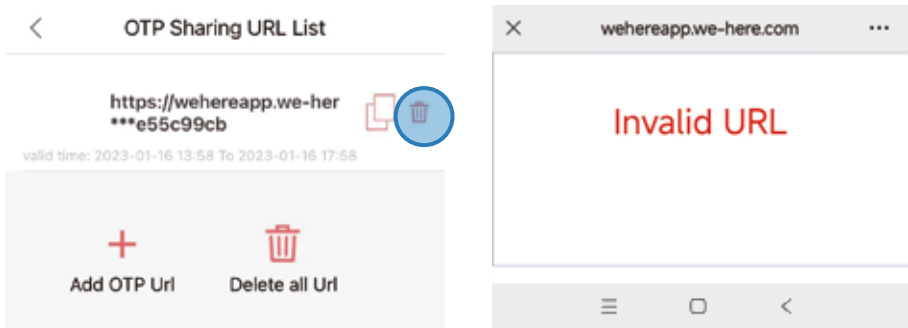



KEY BOX LÖSCHEN

- 1 Box auswählen
- 2 Einstellungen → „Löschen“
- 3 Bestätigen

Folge: Die Box verschwindet aus deiner Geräteliste und ist nicht mehr steuerbar.

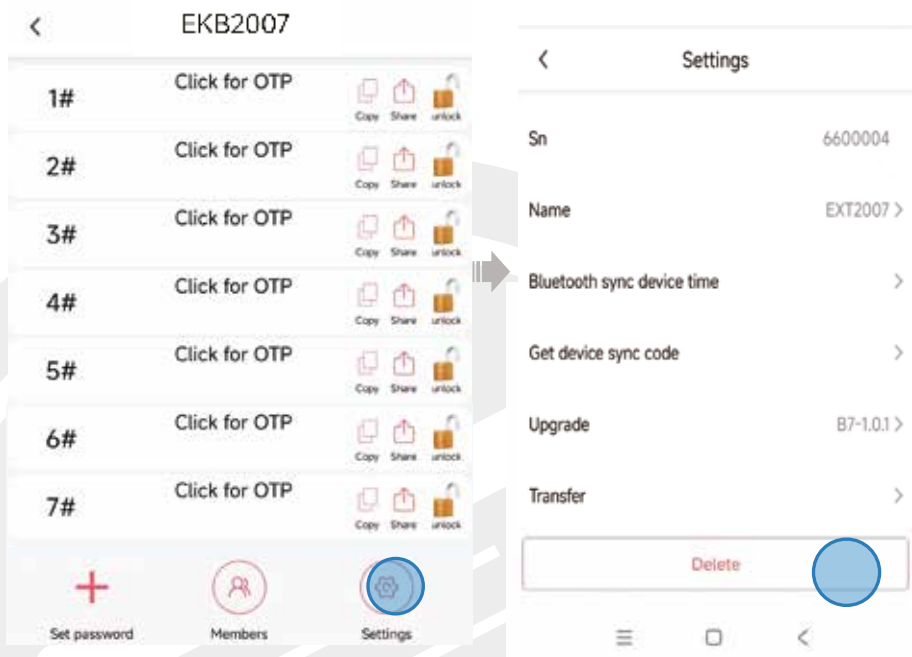



EIGENTUMSÜBERTRAGUNG (TRANSFER)

- ❶ Box auswählen
- ❷ Einstellungen → „Löschen / Übertragen“
- ❸ Account des neuen Besitzers eingeben
- ❹ Bestätigen

Danach ist der neue Nutzer alleiniger Besitzer.

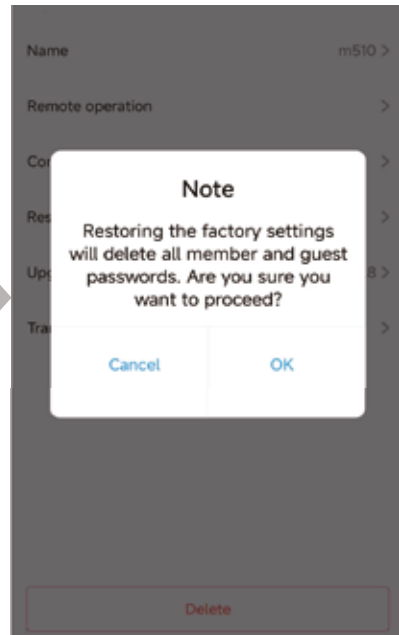
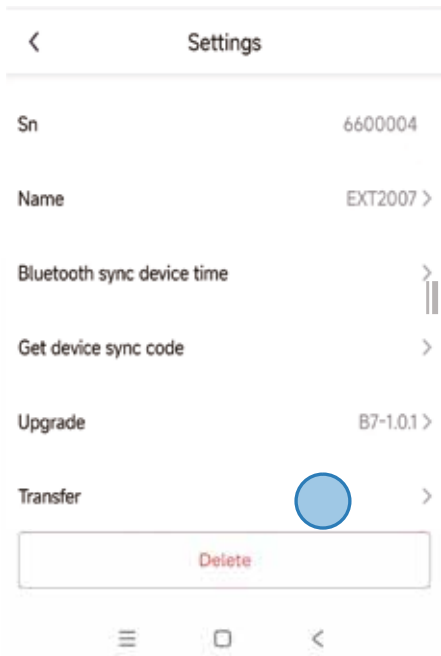



ZEITKALIBRIERUNG DER KEY BOX

Bei langen Betriebszeiten kann die interne Uhr leicht abweichen. Dies kann OTP-Probleme verursachen.

Bluetooth-Zeitabgleich

- 1 Key Box wählen
- 2 Einstellungen → „Bluetooth Zeit synchronisieren“
- 3 Die Box übernimmt automatisch die Uhrzeit des Smartphones

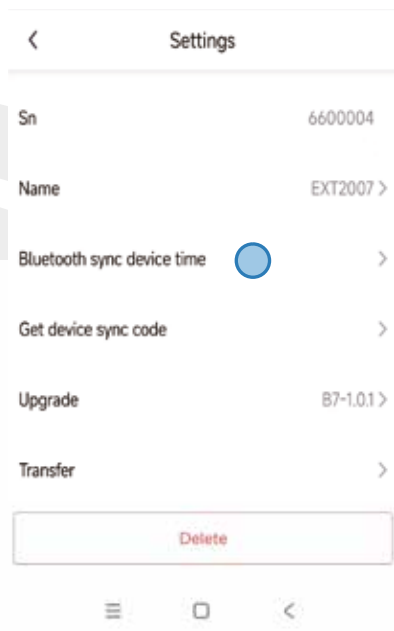
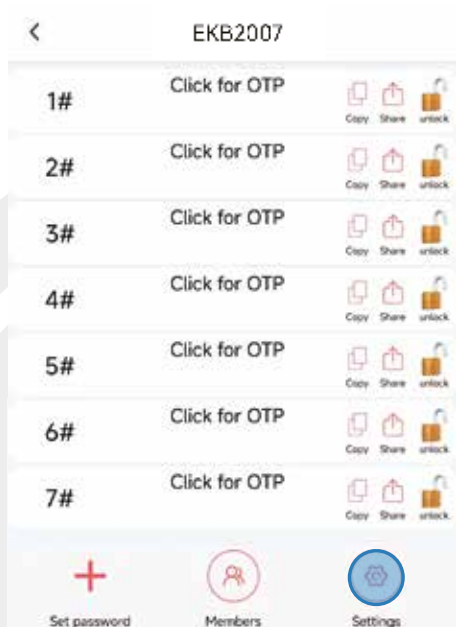



PASSWORTKALIBRIERUNG (SPEZIALCODE)

Nur bei OTP-Problemen notwendig!

- ❶ Key Box wählen
- ❷ Einstellungen → „Gerätesync-Code abrufen“
- ❸ Auf dem Tastenfeld den speziellen Synchronisations-Code eingeben

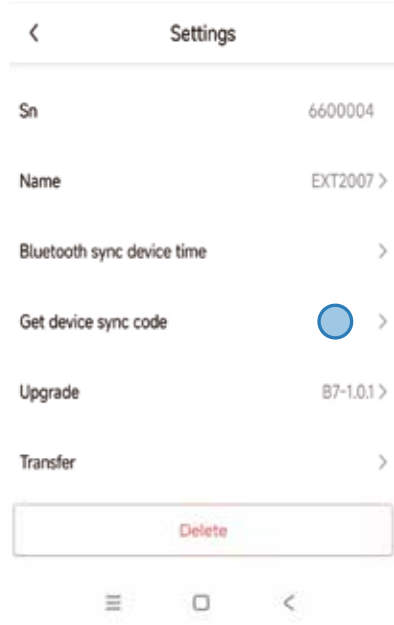
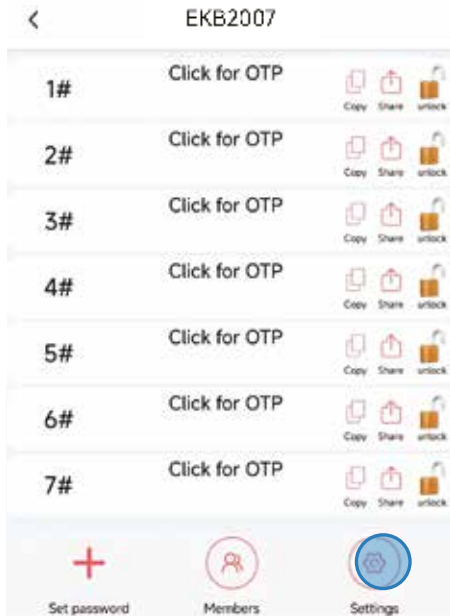

Hinweis: Kalibrierung nur durchführen, wenn OTP nicht funktioniert.





- 1 KEYPAD
- 2 USB TYPE-C POWER SUPPLY PORT
- 3 KEY HOOKS
- 4 KEY GUARD PLATE
- 5 KEY COLLECTION SLOT
- 6 MASTER KEYHOLE
- 7 FRONT DOOR

PARAMETER	SPECIFICATION
Model Number	EKB2007
Power Supply	DC 5V, 1A (via USB Type-C Charging Port)
Key Hooks	7 hooks
Key Retrieval Method	Automatic drop via static password/OTP/bluetooth
Dimensions (L*W*H)	[500 × 125 × 400 mm]
Net Weight	[6kg]
Materials	Metal



HOW TO INSTALL KEYS

Steps:

- 1 Use the Master Key to open the Key Box front door.
- 2 Lift the Key Guard Plate.
- 3 Hang the key on the corresponding key slot
- 4 Lower the Key Guard Plate back into place.
- 5 Close the front door and lock it with the Master Key.
- 6 (Recommended) Test the assigned password or Bluetooth unlock to confirm the key releases correctly.





APP DOWNLOAD

1. Scan the QR code below, or visit the website to download the APP and register for an account.
2. Or you can also search "cloud smart lock" in Google play or App store to download the app and register an account.

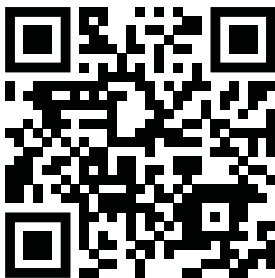

<https://www.cloudsmartlock.com/m/app.html>

ROLES IN THE SYSTEM

There are two roles in the system: Owner and Member.

Owner

- The first user who scans the QR code to bind the Key box becomes the Owner.
- The Owner has full administrative permissions.
- Each key box can have only one Owner.

Member

Member can access the Key box within the permissions assigned by the Owner, such as:

- Bluetooth unlock to release a key
- Managing the password for each key hook
- Share OTP link
- Adding or editing other Members



THERE ARE THREE REGISTRATION METHODS AVAILABLE:

1. Phone Registration

- ① Enter your phone number and request a verification code via SMS.
- ② Input the received code to complete registration

2. Email registration

- ① Enter your email address and request a verification code.
- ② Input the received code to complete registration.

3. User defined account registration

- ① Create a user-defined account by entering a username and password.
- ② Use these credentials for future logins.

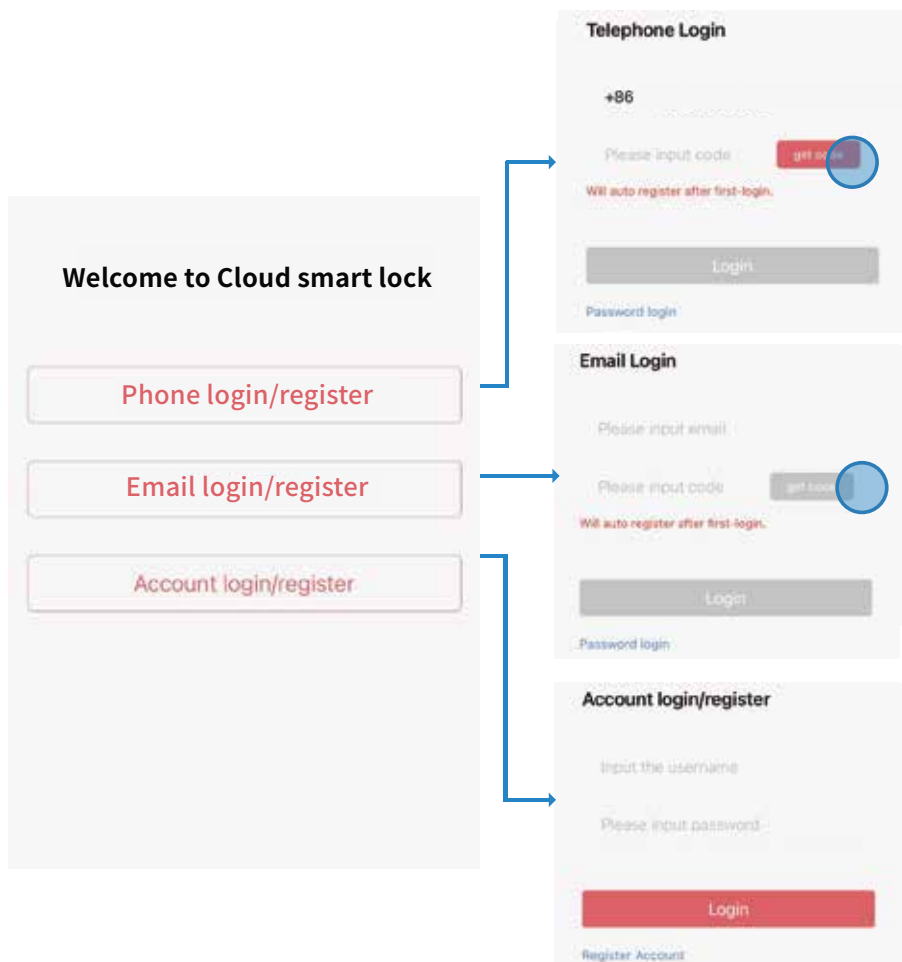



ADDING A KEY BOX TO THE APP

- 1 Open the app and tap the "+" icon to add a new device.
- 2 Scan the QR code located on the front door of the Key Box.
- 3 The first person who binds the key box becomes the Owner and has full permissions.

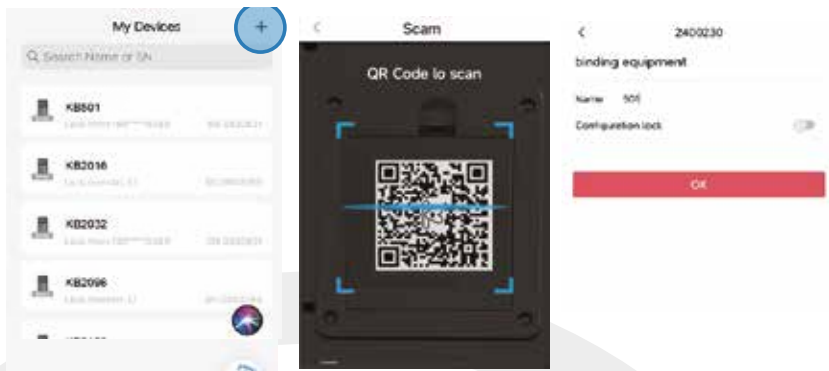

BLUETOOTH UNLOCK TO RELEASE A KEY

Make sure your phone's Bluetooth is turned on and within range of the Key Box.

- 1 Tap the key box you want to manage.
You will enter the operation page, where you can release keys via Bluetooth, manage passwords for each key hook, and more.
- 2 In the key list, locate the key number you need (e.g., 1#, 2#, 3#), then tap the unlock icon.
- 3 The corresponding key will automatically be released and dropped into the Key Collection Slot.

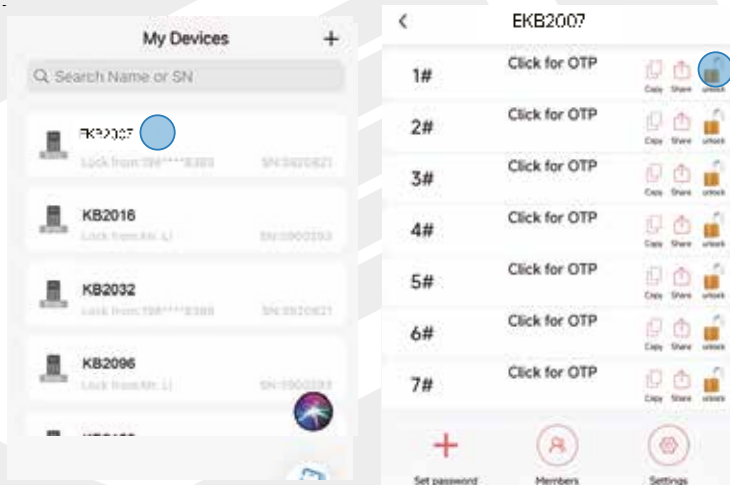



PASSWORD UNLOCK TO RELEASE A KEY

Each key hook supports two types of passwords: static password and OTP (dynamic password)

Dynamic Password (OTP)

- 1 In the key list, locate the key number you need
- 2 Tap [Click for OTP] to generate a one-time password.
- 3 OTP changes automatically every 60 seconds.
- 4 Enter the OTP on the keypad. The corresponding key will be released and dropped into the Key Collection Slot.





Static Password

Each key hook can be assigned one static password.

A static password does not change until it is updated or deleted.

- 1 Tap [Set password]
- 2 Choose the specific key slot you want to configure.
- 3 Tap [Set Password], create a 6-digit security code.
- 4 Save the password via Bluetooth.

Note:

- Each key hook can have both a static password and a dynamic password (OTP).
- A dynamic password (OTP) can only be used once and refreshes automatically every 60 seconds.
- Static passwords can be updated or deleted at any time through the app when your phone is near the Key Box.

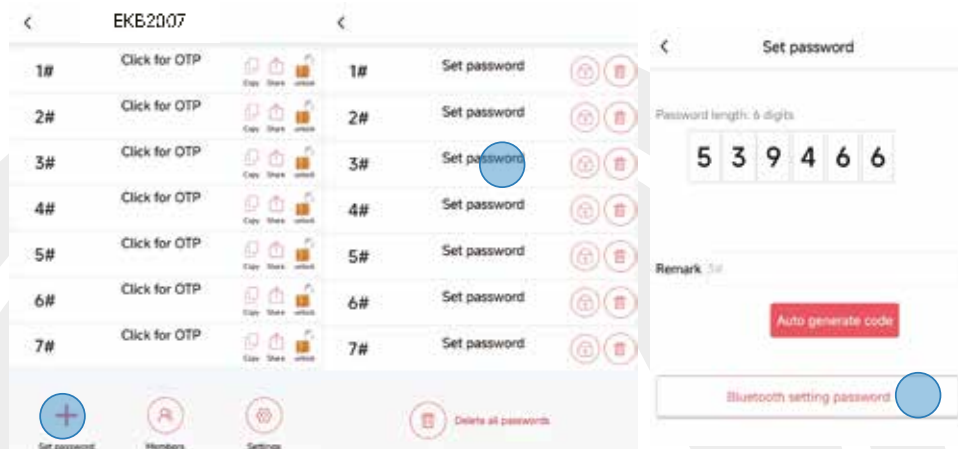



HOW TO ADD A MEMBER

Only the Owner or an authorized Member can add new Members.

- 1 Open [Member] in the app.
 - 2 Tap the "+" icon to add a new user.
 - 3 Enter the user's registered phone number or email address.
- Important:** The phone number or email must belong to a registered account in the app.
- 4 Assign permissions as needed

Note: Once a Member is added, they can log in to their account and see the Key Box listed under [My Devices].

If the Key Box does not appear immediately, pull down the page to refresh.

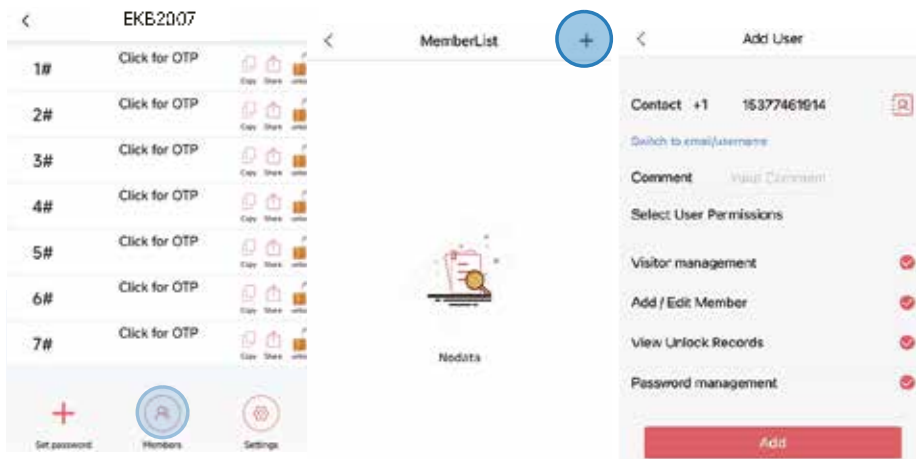

If it doesn't appear immediately, pull down the page to refresh.

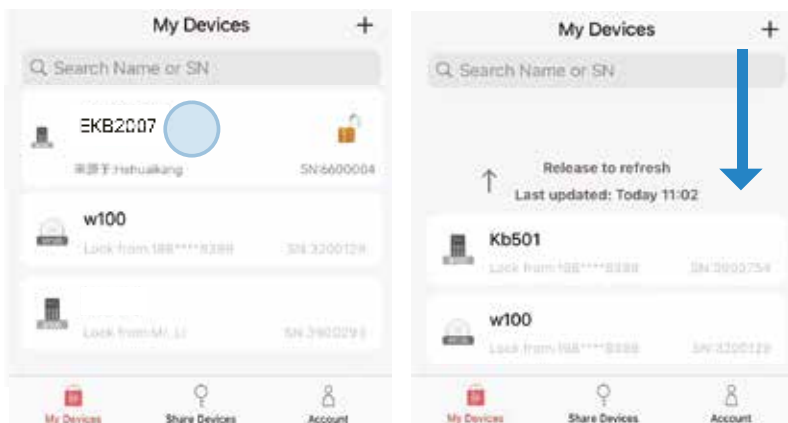



SHARE A DYNAMIC PASSWORD VIA URL

Each key hook allows you to generate a temporary URL to share a dynamic (one-time) password.

Generate a URL

- 1 Open the key box Management page.
- 2 Choose the key slot you want to configure.
- 3 Tap [Share] → [Add OTP URL].
- 4 Set the start time and end time for the URL validity.
- 5 Tap [Save] to create the sharing link.

Note: If [one-time use] is enabled, the link will allow only one dynamic password to be generated within the validity period

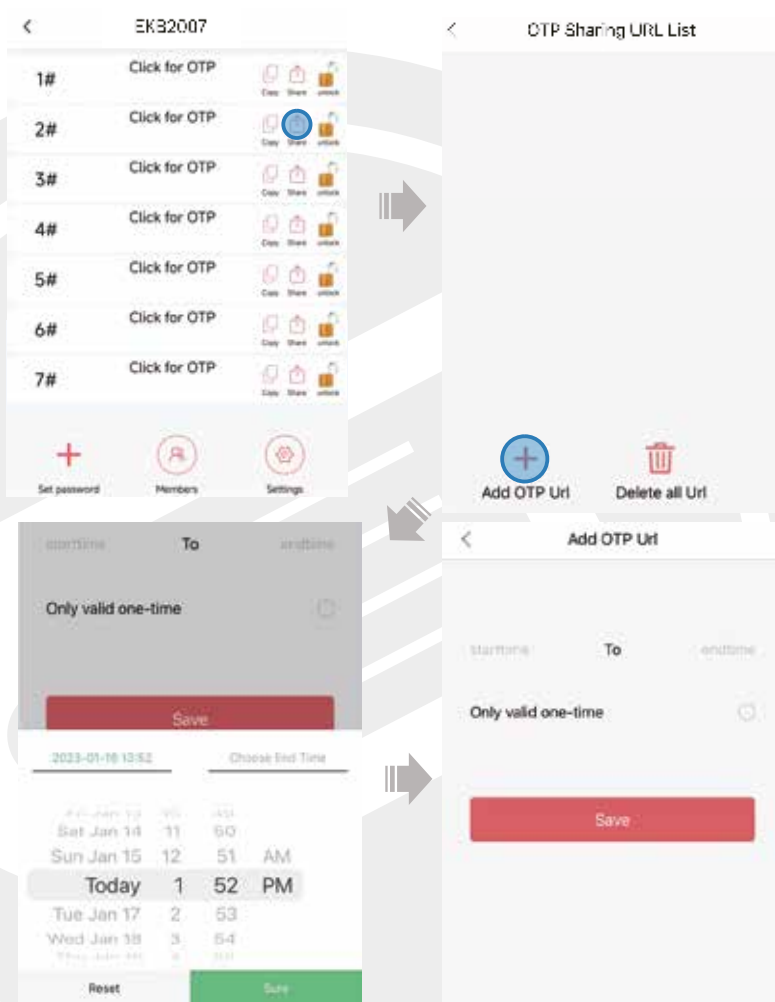



SHARE THE URL

- 1 In the [OTP Sharing URL List], tap the [Copy] icon.
- 2 Paste the link into a text message or email and send it to your guest.
- 3 The guest can open the link to view the dynamic password, which updates every 60 seconds.

Note: The shared URL will only work during the specified validity period.

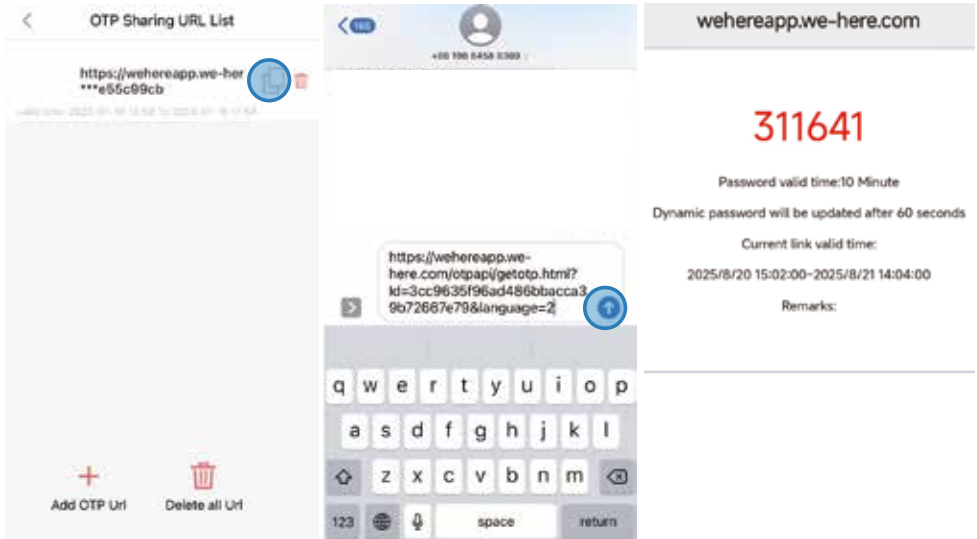

DELETE A URL

- 1 To delete a link, tap the [Delete] icon next to it, or select [Delete All URL].
- 2 Once deleted, the link becomes invalid and cannot be accessed again.

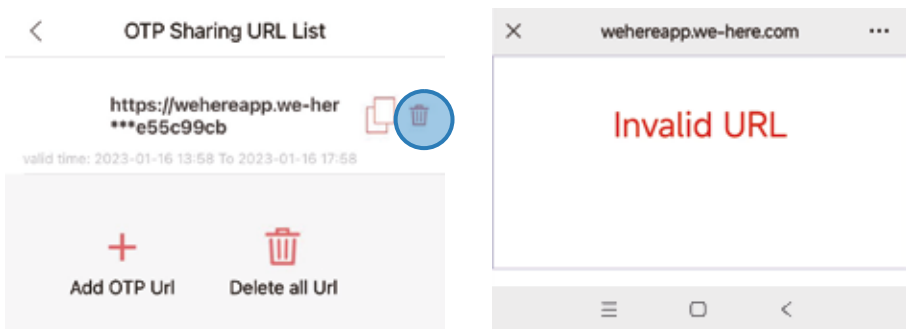



HOW TO DELETE A KEY BOX

If you no longer need a key box, you can remove it from your account.

- 1 Select the key box you want to delete.
- 2 Go to [Settings] → [Delete].
- 3 Confirm deletion.

Note: Once deleted, the key box will be removed from your device list and you will no longer be able to control it from your account.

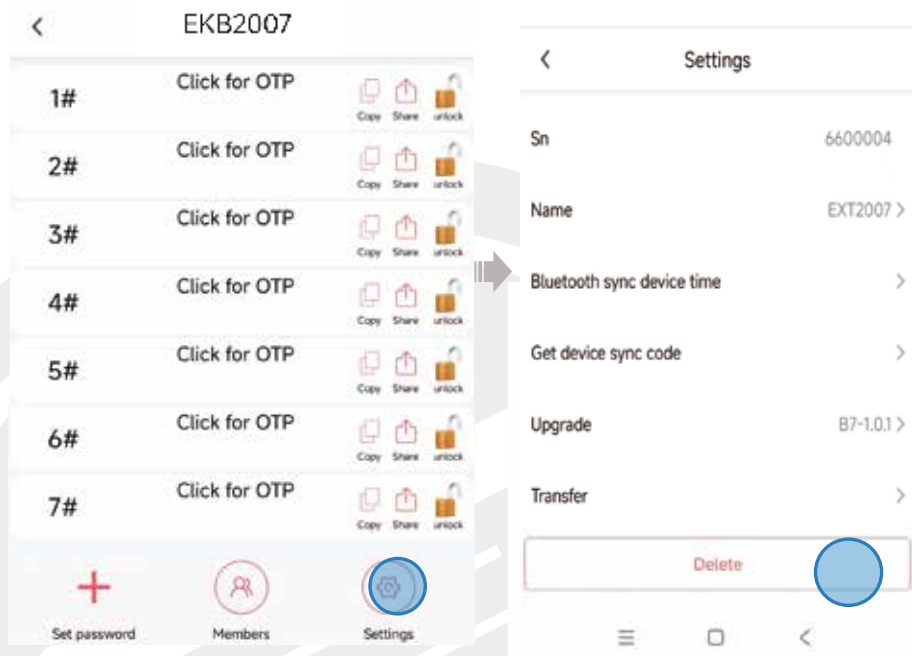



HOW TO TRANSFER A KEY BOX

If you want to give the key box to another person, you can transfer ownership.

- ❶ Select the key box you want to transfer.
- ❷ Go to [Settings] → [Delete].
- ❸ Enter the account (phone number or email) of the new owner.
- ❹ Confirm transfer.

Note: After the transfer is complete, the new account becomes the Owner of the key box, and you will no longer have ownership rights.

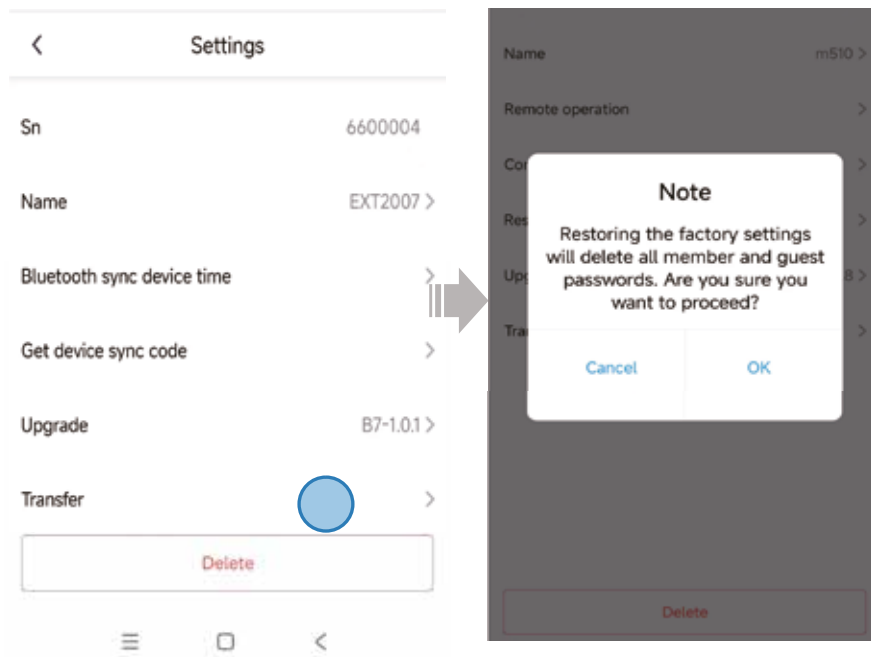



HOW TO CALIBRATE THE KEY BOX TIME

Over long periods of operation, the internal clock of the Key Box may show slight deviations, similar to a watch.

If the device time drifts, it may affect OTP unlocking. In this case, you need to calibrate the Key Box time.

Bluetooth Calibration

- 1 Select the key box you want to calibrate.
- 2 Go to [Settings] → [Bluetooth Sync Device Time].
- 3 The system will automatically synchronize the Key Box time with your mobile device.

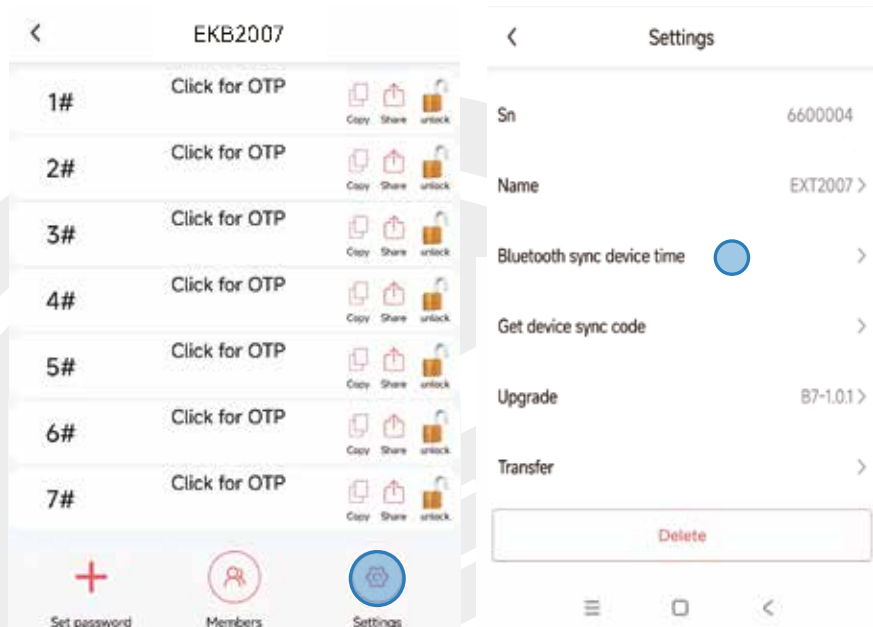



PASSWORD CALIBRATION

- ❶ Select the key box you want to calibrate.
- ❷ Go to [Settings] → [Get device sync code].
- ❸ Enter the special time calibration password on the keypad.

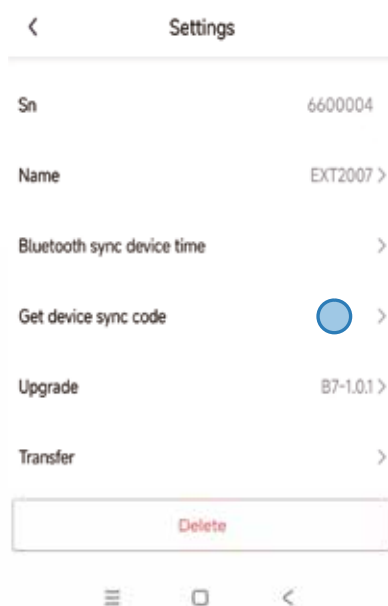
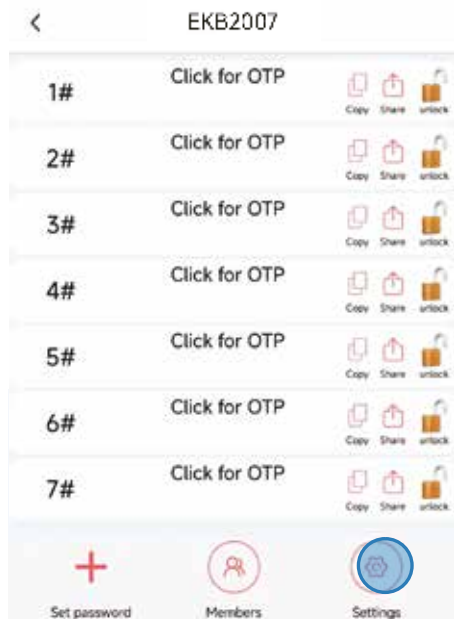

Tips

Time calibration is not required for normal use.
Perform calibration only if you notice that OTP unlocking fails.







 GmbH • Rheinparkallee 9 • 40789 Monheim am Rhein

 +49 2173-164-0 |  +49 2173-164-100 |  info@ahb-international.com

WWW.AHB-SHOP.COM 